

Courses up Monongahala
beg. at a Sug. & running

S. 7°	W.	72P
19°	W.	50P
50°	W.	111P
67°	W.	40P
83	W.	123P
		<hr/>
		396

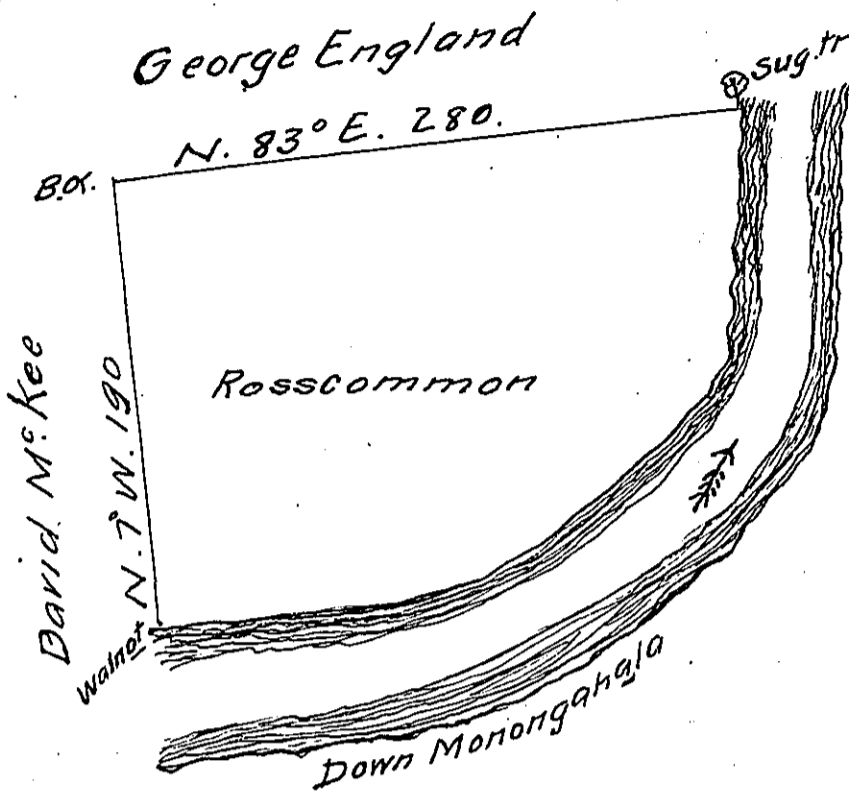

Ordered to be returned on Clames Byers
appⁿ No 2860 dated 6th April 1769 by
Judgement of the Board of Property
dated 1st Sept: 1783 -

In pursuance of an order N^o 3116 dated 20th April 1769 the
above is a draught of a tract of Land call'd Rosscornon
situated on the west side Monongahala containing 269. ⁰/₂^R
acres with the usual allowance of 6 p.c. for Roads Highways &c
Survey^d for Alexander Ross 25th November 1769 by

To

James Hendricks

John Lukens Esq.

Surveyor General

IN TESTIMONY that the above is a copy of the original remaining on file in
the Department of Internal Affairs of Pennsylvania, made
conformably to an Act of Assembly approved the 16th day of
February, 1833, I have hereunto set my Hand and caused
the Seal of said Department to be affixed at Harrisburg,
this tenth day of August 1911

Henry Howell,
Secretary of Internal Affairs.